

aiwa



PLUG-IN HEATER

USER MANUAL

Model Number: WSH3-1003-WHT

Customer Service: 833-902-2335

aiwasupport@xtremeconnected.com

IMPORTANT SAFETY INFORMATION

WARNING!!

IMPORTANT INSTRUCTIONS:

WHEN USING ELECTRICAL APPLIANCES, BASIC PRECAUTIONS SHOULD ALWAYS BE FOLLOWED TO REDUCE THE RISK OF FIRE, ELECTRIC SHOCK, AND INJURY TO PERSONS, INCLUDING THE FOLLOWING:

CAUTION: TO REDUCE THE ELECTRIC SHOCK, DO NOT REMOVE THE COVER (OR BACK). NO USER SERVICEABLE PART INSIDE, REFER SERVICING TO QUALIFIED SERVICE PERSONNEL.

READ ALL INSTRUCTIONS BEFORE USING THIS HEATER

- Use this heater only as directed in this manual. Any other use not recommended by the manufacturer may cause malfunction, overheating, fire, property damage, electric shock, and death or injury to persons.
- Plug this heater into a 120VAC / 60Hz.15-amp (or more) electrical circuit, as determined by that circuit's circuit breaker or fuse rating. Make sure that nothing else is plugged into that same circuit as that could exceed the circuit's rating.
- Plug this heater into a properly grounded, 3-prong wall outlet only. Make sure that the plug fits tightly in the outlet.
- Never plug it this heater into an extension cord, relocatable power tap or power strip, surge protectors, timers, or an outlet with other appliances connected to the same outlet.
- Plugging into a ground fault circuit interrupter (GFCI) outlet is not recommended as the high energy requirements of the heater may cause nuisance tripping. If the tripping of a GFCI outlet does occur, connect the heater to a standard wall outlet.
- Unplug heater when not in use.
- This heater is not to be used in bathrooms, laundry areas or other similar indoor moist or wet locations. Never place the heater where it may fall into a bathtub or other water container. Do not touch with a wet hand.
- For indoor residential use only. Do not use outdoors.
- This heater is hot when using. To avoid burns, do not let bare skin touch hot surfaces. Use grip handle when provided

- Operate this heater free from obstructions. Keep combustible materials such as drapes, furniture, pillows, bedding, papers, clothes, and curtains at least three (3) feet (0.9m) from the front of heater and keep them at least 1 foot (0.3m) from the sides and rear of the heater.



- The heater has hot and arcing or sparking parts inside. Do not use it in areas where gasoline, paint or flammable liquids are used or stored.
- Risk of electric shock. DO NOT open. No user serviceable parts inside. Do not disassemble, modify, or try to use for a non-intended purpose, and do not use if damaged or modified. Any tampering with, or modification can result in serious injury, death, or fire.
- To prevent possible fire, do not block air intakes or exhaust in any manner. Do not use on soft surfaces, like a bed, where openings may become blocked.
- Do not insert or allow foreign objects to enter any ventilation or exhaust opening as this may cause electric shock, fire or damage to the heater.
- Some homes are wired with aluminum wiring. If your home has aluminum wiring, to avoid any safety issue, have a licensed electrician check your receptacle's connections before plugging in an electrical product such as a room heater.
- Before cleaning, or storage, or when not in use, turn the product's controls to the OFF position and unplug the heater from the electrical outlet and allow to cool.
- This appliance is not intended for use by children or those requiring supervision. Extreme caution is necessary when heater is used and whenever the heater is left operating and unattended.

SAVE THESE INSTRUCTIONS

CONTROL PANEL

1. Heating grid
2. On/off switch and power
3. LED display
4. Temperature controller +
5. Temperature controller -
6. Timer (Timer /Temperature switch conversion)
7. On/off switch
8. Contour plug
9. Plug rotation button
10. Ventilation grille

CAUTION: This side must always face upwards.
Do not operate in any other orientation.





INSTRUCTION FOR USE

NOTE: Powering off the heater will stop the heating process only. The fan will continue to blow for approximately 60 seconds to allow for the interior components to cool. After 60 seconds, the heater will shut down automatically.

1. Plug rotation fits most outlets. See diagram #9 Press in button until the plug rotates to your needed alignment. 0-90-180. It will "click" into place. Please note warning: Heater must always face up as mentioned in warnings.
2. Do NOT plug this heater into a surge protector. This heater must be plugged in upright. Do NOT use this heater plugged in lying down.
3. The control panel shows a display of the temperature and timer.
4. This device is only for use in well-insulated rooms or for occasional use.



NOTE: The heater must be positioned upright (With the control panel being at the top). The distance between the heater bottom and the ground should be more than 30cm, while the distance between the side of the heater and the wall or any other object should be more than 50cm.

OPERATING INSTRUCTIONS

1. Press the "I/O" Switch" on side of the unit to the "I" position to turn on the heater. After doing this, the Power indicator will light up and the LED display will show "OF".
2. Press the power  button to start your heater. After doing this, the fan will start up and remain on. To switch between High "HH" and Low "LL" heating modes, press this button again. To power off, press the power button again until Off "OF" is displayed on the screen.
3. Press the "+" button to increase the temperature setting in High and Low modes. The highest temperature setting that this heater can reach is 95°F.
4. Press the "-" button to decrease the temperature setting in High and Low modes. The lowest temperature that this heater can reach is 59°F.
5. Press and hold the Timer/Temperature switch button  for 3 seconds to change the temperature units between "°F" and "°C".
6. Single press the Timer/Temperature switch button  to set timer (0-24hours).

- When finished, Press the power  button to power off the heater. The LED display will show "0F", and the fan will turn off automatically after 60 seconds. Switch the power switch at the side of the heater to "0" position and unplug heater from power outlet.

TIMER INSTRUCTIONS

- When the heater is running, Press the Timer/Temperature switch button , to change the digital display from the temperature option to the hours option for the timer. Continue to press this button to change the number of hours you would like the heater to run before powering itself off. The hour options for the timer are from 0 to 24 hours in 1 hour increments.
- When the heater is off, Press the Timer/Temperature switch button , to display the hours option for the timer. Continue to press this button to change the number of hours you would like the heater's internal clock to count down before powering itself on. The hour options for the timer are from 0 to 24 hrs. (in 1 hour increment).
- To turn off the auto shut-off timer, press the Timer/Temperature switch button until the LED display shows "0"

OVERHEATING SAFETY FEATURE

WARNING: It is normal for the rear of the heater to feel warm to the touch however, a loose fit between the outlet and the plug may cause overheating of the plug. If this occurs, try inserting the plug into a different outlet. Contact a qualified electrician to inspect the original outlet for damage. This heater is equipped with an internal overheating safety feature. When the heater's internal components reach a certain temperature that may cause overheating and possible fire, the heater will automatically shut off. Allow the heater to cool for 15 minutes, then plug it back in and power it on. Overheating can be caused by the obstruction to the air intakes on the back of the machine or the grill on the front.

CAUTION: NEVER COVER THE HEATER AS THIS MAY LEAD TO RISK OF FIRE. HEATER MUST BE ALWAYS FACING UPRIGHT.

NOTE: See diagram for plug rotation positioning.

You will need to **press** this **button** to rotate the plug.

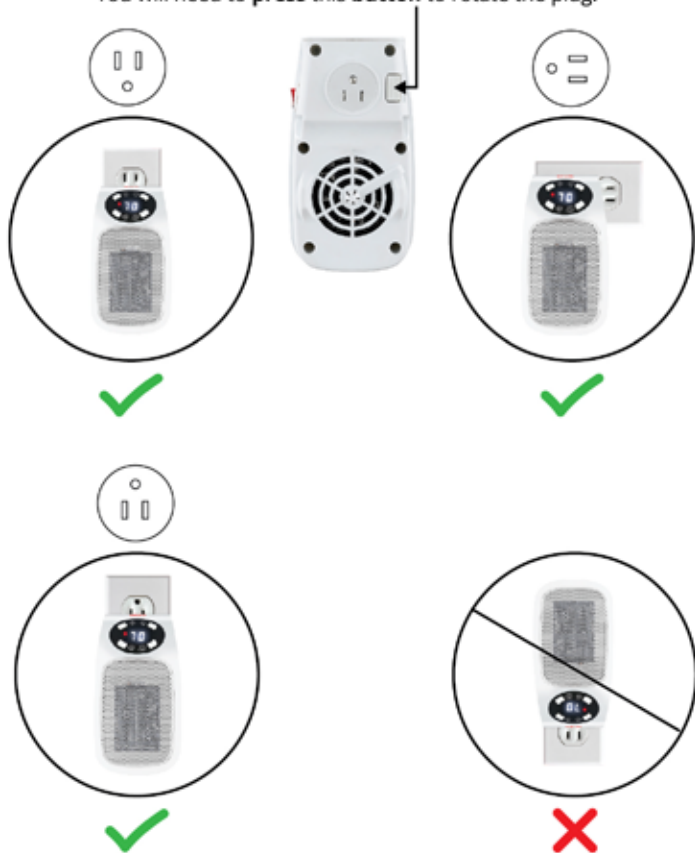

CLEANING

1. Flip the Power switch to "0" turn off the heater
2. Unplug the unit and let it cool completely
3. To keep the heater clean, the outer shell may be cleaned with a soft damp cloth. You may use a mild detergent if necessary. After cleaning, dry the unit with a soft cloth
4. DO NOT let liquid enter the heater
5. DO NOT use alcohol, gasoline, abrasive powders, furniture polish, or rough brushes to clean the heater. This may cause damage or deterioration to the surface of the heater.
6. DO NOT immerse the heater in water.
7. Wait until the unit is completely dry before use.

STORAGE

Store the heater in a cool, dry location when not in use. To prevent dust and dirt build-up, use the original packaging to repack the unit.

BASIC TROUBLESHOOTING

If the heater will not operate, please check the following before seeking repair advice:

1. Check if the plug is plugged into an electrical outlet, if not, plug it in.
2. Check if the electricity to the electrical outlet is working.
3. Check for signs of overheating and refer to the Overheating Safety Feature section.

SERVICE INSTRUCTIONS

DO NOT ATTEMPT TO REPAIR OR ADJUST ANY ELECTRICAL OR MECHANICAL FUNCTIONS ON THIS UNIT. DOING SO WILL VOID THE WARRANTY.

SPECIFICATIONS

Voltage: 120V-60Hz

Wattage: 400 Watts

Amperage: 3.33A

Heating coverage: 64.6 sq. ft

Weight: 1 pound

Dimension: L(4.2") x W(3.2") x H(7.5")

Adjustable temperature

Timer (24 hours)

ONE YEAR WARRANTY

AIWA warrants its products for one year against defects in manufacturing under regular consumer use with original receipt of retail purchase. We believe in our products and want to provide you with a replacement, if needed, but we have to know about the problem while the product is still under warranty. If you discover a defect covered by this warranty, please contact us about receiving a replacement. In order to use the products warranty the customer must provide proof of the retailers receipt.

*Any customers outside of the U.S. will be responsible for shipping and handling charges if a replacement is required that is not due to a manufacturing defect. If there is not a manufacturing defect, shipping and handling will be applied.

AIWA's warranty is limited to our products only. Our warranty does not cover the replacement or repair cost of any third-party accessory, electronic device or personal property.

For instructions about how to obtain warranty service for your product and product support, please contact Customer Service: 833-902-2335.

Content is subject to change without prior notice. Some content may differ from how the product works with your specific device.

Includes:

Portable Room Heater, User Manual

©2023 Aiwa Acquisitions LLC. AIWA and associated marks are owned by Aiwa Acquisitions and used under license.

Licensed and Manufactured by Xtreme Connected Home, Inc.

Please call for customer support: 833-902-2335.

aiwasupport@xtremeconnected.com